

ROULUNDS
RUBBER

2008
Power Transmission Products Industry
List of Dimensions



Table of Contents

PROGRAM 10 - ROFLEX RE-X Narrow Section Raw-Edge V-Belts	2
PROGRAM 11 - ROFLEX Narrow Section Wrapped V-Belts	4
PROGRAM 12 - ROFLEX-X Narrow Section Raw-Edge V-Belts	6
PROGRAM 15 - ROFLEX Classical Section Wrapped V-Belts	8
PROGRAM 16 - ROFLEX-X Classical Section Raw-Edge V-Belts	12
PROGRAM 17 - ROFLEX RE-X Classical Section Raw-Edge V-Belts	14
PROGRAM 21 - ROFLEX Double-Sided V-Belts	15
PROGRAM 23 - ROFLEX Banded V-Belts	17
PROGRAM 33 - ROFLEX Multiribbed Belts	20
PROGRAM 34 - RO-DRIVE Synchronous Belts	22
PROGRAM 34 - RO-DRIVE TORQUE Synchronous Belts	26
PROGRAM 34 - RO-DRIVE PLUS Synchronous Belts	27
PROGRAM 34 - RO-DRIVE TWIN PLUS Double-Sided Synchronous Belts	30
PROGRAM 34 - RO-DRIVE TWIN Double-Sided Synchronous Belts	32
PROGRAM 34 - RO-DRIVE Open Ended Synchronous Belts	34
PROGRAM 40 - ROFLEX-VARI Raw-Edge Cogged Belts	35
CROSS LISTS	39

ROFLEX RE-X Narrow Section Raw-Edge V-Belts

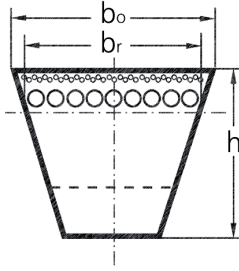

SECTION	ISO 4184, BS 3790 DIN 7753/1 RMA/MTPA IP-22	XPZ	XPA	XPB	XPC	3VX/9NX	5VX/15NX
Belt width (top)	b_o [mm] \approx	9,7	12,7	16,3	22	9	15
Datum width	b_r [mm]	8,5	11	14	19		
Belt thickness	h [mm] \approx	8	9	13	18	8	13
Datum length	$L_i \approx L_e$ - [mm]					4	11
Inner length	$L_i \approx L_r$ - [mm]	37	45	60	69		
Outer length	$L_a \approx L_r$ - [mm]	13	18	22	30		
Minimum datum pulley diameter	d_r [mm]	50	63	100	160		
Weight	[kg/m] \approx	0,065	0,105	0,190	0,325		
Maximum bending frequency	f [Hz]					120	
Recommended maximum belt speed	v [m/s]					50	

* On request

Section XPZ / 3VX

L_r (mm)	L_r (inch)	
562	22,13	
587	23,11	
612	24,09	
630	24,80	3VX 250
637	25,08	
662	26,06	3VX 260
670	26,38	3VX 265
687	27,05	
710	27,95	3VX 280
722	28,43	
737	29,02	
750	29,53	
762	30,00	3VX 300
772	30,39	
780	30,71	
787	30,98	
795	31,30	
800	31,50	3VX 315
812	31,97	
825	32,48	
837	32,95	
850	33,46	3VX 335
862	33,94	
875	34,45	
887	34,92	3VX 350
900	35,43	3VX 355
912	35,91	
925	36,42	
930	36,61	
937	36,89	3VX 370
950	37,40	3VX 375
962	37,87	
987	38,86	
1000	39,37	
1012	39,84	3VX 400
1024	40,31	
1037	40,83	
1047	41,22	
1060	41,73	
1077	42,40	3VX 425
1087	42,80	
1112	43,78	
1120	44,09	
1137	44,76	3VX 450
1150	45,28	
1162	45,75	
1180	46,46	
1187	46,73	

Section XPZ / 3VX

L_r (mm)	L_r (inch)	
1200	47,24	3VX 475
1202	47,32	3VX 475
1212	47,72	
1237	48,70	
1250	49,21	
1262	49,68	3VX 500
* 1270	50,00	
1287	50,67	
1312	51,65	
1320	51,97	3VX 520
1337	52,64	
1340	52,76	3VX 530
1347	53,03	
1362	53,62	
1387	54,61	
1400	55,12	
1412	55,59	
1420	55,91	3VX 560
1437	56,57	
1462	57,56	
1487	58,54	
1500	59,06	
1512	59,53	
1520	59,84	3VX 600
1537	60,51	
1550	61,02	
1562	61,50	3VX 617
1587	62,48	
1600	62,99	3VX 630
1612	63,46	
1637	64,45	
1650	64,96	
1662	65,43	
1687	66,42	
1700	66,93	3VX 670
* 1737	68,39	
1750	68,90	
1762	69,37	
1787	70,35	
1800	70,87	3VX 710
* 1812	71,34	
1837	72,32	
1850	72,83	
1862	73,31	
1887	74,29	
1900	74,80	3VX 750
1937	76,26	
1950	76,77	

Section XPZ / 3VX

L_r (mm)	L_r (inch)	
1987	78,23	
2000	78,74	
2037	80,20	3VX 800
2060	81,10	
2120	83,46	
2137	84,13	
2160	85,04	3VX 850
2187	86,10	
2240	88,19	
2287	90,04	3VX 900
2360	92,91	
2410	94,88	3VX 950
* 2437	95,94	
2500	98,43	
2540	100,00	3VX 1000
2650	104,33	
2685	105,71	3VX 1060
2800	110,24	
2840	111,81	3VX 1120
3000	118,11	3VX 1180
3150	124,02	
3170	124,80	3VX 1250
3350	131,89	3VX 1320
3550	139,76	3VX 1400

Section XPA

L_r (mm)	L_r (inch)
1032	40,63
1060	41,73
1082	42,60
1107	43,58
1120	44,09
1132	44,57
1150	45,28
1157	45,55
1180	46,46
1207	47,52
1232	48,50
1250	49,21
1257	49,49
1272	50,08
1282	50,47
1307	51,46
1320	51,97
1332	52,44
1357	53,43
1382	54,41
1400	55,12
1407	55,39
1432	56,38
1450	57,09
1457	57,36
1482	58,35
1500	59,06
1507	59,33
1532	60,31
1550	61,02
1557	61,30
1582	62,28
1600	62,99
1607	63,27
1632	64,25
1650	64,96
1657	65,24
1682	66,22
1700	66,93
* 1725	67,91
1732	68,19
1750	68,90
1757	69,17
1782	70,16
1800	70,87
1807	71,14
1832	72,13
1850	72,83

Section XPA

L_r (mm)	L_r (inch)
732	28,82
757	29,80
782	30,79
800	31,50
807	31,77
832	32,76
850	33,46
857	33,74
882	34,72
900	35,43
907	35,71
925	36,42
932	36,69
950	37,40
957	37,68
967	38,07
975	38,39
982	38,66
1000	39,37
1007	39,65

ROFLEX RE-X Narrow Section Raw-Edge V-Belts

Section XPA

L _r (mm)	L _r (inch)
1857	73,11
1882	74,09
1900	74,80
1907	75,08
1932	76,06
1950	76,77
1957	77,05
* 1970	77,56
1982	78,03
2000	78,74
* 2020	79,53
2032	80,00
2057	80,98
2082	81,97
2120	83,46
2132	83,94
2160	85,04
2182	85,91
2207	86,89
2240	88,19
2282	89,84
2300	90,55
2307	90,83
2332	91,81
2360	92,91
2382	93,78
2432	95,75
2482	97,72
2500	98,43
2532	99,68
2582	101,65
* 2607	102,64
2632	103,62
2650	104,33
2682	105,59
2732	107,56
2782	109,53
2800	110,24
2832	111,50
2882	113,46
2932	115,43
* 2982	117,40
3000	118,11
* 3032	119,37
* 3082	121,34
3150	124,02
3182	125,28
3250	127,95
* 3282	129,21
3350	131,89
* 3382	133,15
3450	135,83
3550	139,76
* 3650	143,70
3750	147,64
* 3800	149,61
* 3850	151,57
* 3900	153,54
* 3950	155,51
4000	157,48
4250	167,32
4500	177,17

Section XPB / 5VX

L _r (mm)	L _r (inch)
* 1043	41,06
1250	49,21
1260	49,61 5VX 500
* 1270	50,00
1285	50,59
1320	51,97
1340	52,76 5VX 530
1350	53,15
1360	53,54
1400	55,12
1410	55,51 5VX 560
1440	56,69
1450	57,09
1470	57,87
1500	59,06 5VX 600
1525	60,04
1550	61,02
1590	62,60
1600	62,99 5VX 630
1610	63,39
1640	64,57
1650	64,96
1690	66,54
1700	66,93 5VX 670
1750	68,90
1780	70,08
1800	70,87 5VX 710
1850	72,83 5VX 730
1900	74,80 5VX 750
1950	76,77
2000	78,74
2020	79,53 5VX 800
2050	80,71
2060	81,10
2080	81,89
* 2100	82,68
2120	83,46 5VX 840
2150	84,65 5VX 850
2180	85,83
2240	88,19
* 2270	89,37
2285	89,96 5VX 900
2300	90,55
2360	92,91
* 2400	94,49
2410	94,88 5VX 950
2430	95,67
2450	96,46
2500	98,43
2530	99,61 5VX 1000
2580	101,57
2630	103,54
2650	104,33
2680	105,51 5VX 1060
2710	106,69
2730	107,48 5VX 1080
2800	110,24
2840	111,81 5VX 1120
2900	114,17
3000	118,11 5VX 1180
3150	124,02
3170	124,80 5VX 1250
* 3210	126,38
3250	127,95
3350	131,89 5VX 1320
3450	135,83
3550	139,76 5VX 1400
3650	143,70

Section XPB / 5VX

L _r (mm)	L _r (inch)
3750	147,64
3800	149,61 5VX 1500
3870	152,36
* 3950	155,51
4000	157,48
4060	159,84 5VX 1600
4120	162,20
* 4150	163,39
4250	167,32
4310	169,68 5VX 1700
4370	172,05
4500	177,17
4560	179,53 5VX 1800
4620	181,89
4750	187,01
4820	189,76 5VX 1900
5000	196,85

Section XPC

L _r (mm)	L _r (inch)
* 1792	70,55
1900	74,80
2000	78,74
2120	83,46
2240	88,19
2280	89,76
2360	92,91
2500	98,43
2650	104,33
2800	110,24
3000	118,11
3150	124,02
3350	131,89
3550	139,76
3650	143,70
3750	147,64
4000	157,48
* 4060	159,84
4100	161,42
4250	167,32
4310	169,68
4500	177,17
4750	187,01
5000	196,85

ROFLEX Narrow Section Wrapped V-Belts

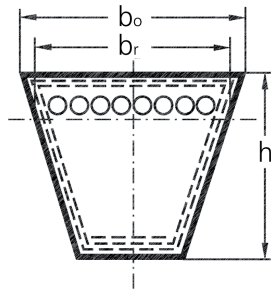

SECTION	ISO 4184, BS 3790 DIN 7753/1 RMA/MTPA IP-22	SPZ	SPA	SPB	SPC	19*	3V/9N	5V/ 15N	8V/ 25N
Belt width (top)	b_o [mm] \approx	9,7	12,7	16,3	22	18,6	9	15	25
Datum width	b_r [mm]	8,5	11	14	19	16			
Belt thickness	h [mm] \approx	8	10	13	18	15	8	13	23
Datum length	$L_r \approx L_e$ - [mm]						4	11	16
Inner length	$L_i \approx L_r$ - [mm]	37	45	60	83	69			
Outer length	$L_a \approx L_r$ - [mm]	13	18	22	30	25			
Minimum datum pulley diameter	d_r [mm]	63	90	140	224	180			
Weight	[kg/m] \approx	0,065	0,115	0,200	0,350	0,275			0,520
Maximum bending frequency	f [Hz]	100							
Recommended maximum belt speed	v [m/s]	42							

* On request

Section SPZ / 3V

L_r (mm)	L_r (inch)
512	20,16
562	22,13
587	23,11
612	24,09
630	24,80 3V 250
637	25,08
662	26,06 3V 260
670	26,38 3V 265
687	27,05
710	27,95 3V 280
737	29,02
750	29,53
762	30,00 3V 300
772	30,39
780	30,71
787	30,98
800	31,50 3V 315
812	31,97
825	32,48
837	32,95
850	33,46 3V 335
862	33,94
875	34,45
887	34,92 3V 350
900	35,43 3V 355
912	35,91
925	36,42
937	36,89 3V 370
950	37,40 3V 375
962	37,87
987	38,86
1000	39,37
1012	39,84 3V 400
1024	40,31
1037	40,83
1047	41,22
1060	41,73
1077	42,40 3V 425
1087	42,80
1112	43,78
1120	44,09
1137	44,76 3V 450
1150	45,28
* 1151	45,31
1162	45,75
1180	46,46
1187	46,73

Section SPZ / 3V

L_r (mm)	L_r (inch)
1202	47,32 3V 475
1212	47,72
1237	48,70
1250	49,21
1262	49,68
1270	50,00 3V 500
1287	50,67
1312	51,65
1320	51,97 3V 520
1337	52,64
1347	53,03
1362	53,62
1387	54,61
1400	55,12
1412	55,59
1420	55,91 3V 560
1437	56,57
1462	57,56
* 1470	57,87
1487	58,54
1500	59,06
1512	59,53
* 1520	59,84 3V 600
1537	60,51
1562	61,50
1587	62,48
1600	62,99 3V 630
1612	63,46
1637	64,45
1650	64,96
1662	65,43
1687	66,42
1700	66,93 3V 670
1737	68,39
1762	69,37
1787	70,35
1800	70,87 3V 710
1812	71,34
1837	72,32
1850	72,83
1862	73,31
1887	74,29
1900	74,80 3V 750
1937	76,26
1987	78,23
2000	78,74
2037	80,20 3V 800

Section SPZ / 3V

L_r (mm)	L_r (inch)
2087	82,17
2120	83,46
2137	84,13
2160	85,04 3V 850
2187	86,10
2240	88,19
* 2257	88,86
2287	90,04 3V 900
2360	92,91
2410	94,88 3V 950
2500	98,43
2540	100,00 3V 1000
2650	104,33
* 2685	105,71
2690	105,91 3V 1060
* 2787	109,72
2800	110,24
2840	111,81 3V 1120
3000	118,11 3V 1180
3150	124,02
* 3170	124,80
3350	131,89 3V 1320
3550	139,76 3V 1400

Section SPA

L_r (mm)	L_r (inch)
1082	42,60
1107	43,58
1120	44,09
1132	44,57
1157	45,55
1180	46,46
1207	47,52
1232	48,50
1250	49,21
1257	49,49
1272	50,08
1282	50,47
1307	51,46
1320	51,97
1332	52,44
1357	53,43
1382	54,41
1400	55,12
1407	55,39
1432	56,38
1457	57,36
1482	58,35
1500	59,06
1507	59,33
1532	60,31
1557	61,30
1582	62,28
1600	62,99
1607	63,27
1632	64,25
* 1655	65,16
1657	65,24
1682	66,22
1700	66,93
1707	67,20
1732	68,19
1757	69,17
1782	70,16
1800	70,87
1807	71,14
1832	72,13
1857	73,11
1882	74,09
1900	74,80
1907	75,08
1932	76,06
1950	76,77

Section SPA

L_r (mm)	L_r (inch)
732	28,82
* 757	29,80
782	30,79
800	31,50
* 807	31,77
832	32,76
850	33,46
857	33,74
882	34,72
900	35,43
907	35,71
932	36,69
950	37,40
957	37,68
967	38,07
982	38,66
1000	39,37
1007	39,65
1032	40,63
1060	41,73

ROFLEX Narrow Section Wrapped V-Belts

Section SPA

L _r (mm)	L _r (inch)
1957	77,05
1982	78,03
2000	78,74
2020	79,53
2032	80,00
2057	80,98
* 2075	81,69
2082	81,97
2120	83,46
2132	83,94
2182	85,91
2207	86,89
2232	87,87
2240	88,19
2282	89,84
2300	90,55
2307	90,83
2332	91,81
2360	92,91
2382	93,78
2432	95,75
2482	97,72
2500	98,43
2532	99,68
2582	101,65
2607	102,64
2632	103,62
2650	104,33
2682	105,59
2732	107,56
2782	109,53
2800	110,24
2832	111,50
2847	112,09
2882	113,46
2900	114,17
2932	115,43
2982	117,40
3000	118,11
3032	119,37
3082	121,34
3150	124,02
3182	125,28
* 3250	127,95
3282	129,21
3350	131,89
3382	133,15
3450	135,83
* 3482	137,09
3550	139,76
* 3650	143,70
3750	147,64
4000	157,48
4250	167,32
4500	177,17

Section SPB / 5V

L _r (mm)	L _r (inch)
1250	49,21
* 1260	49,61
1320	51,97
1400	55,12
* 1440	56,69
1450	57,09
1500	59,06
1600	62,99
1700	66,93

Section SPB / 5V

L _r (mm)	L _r (inch)
1750	68,90
1800	70,87
1850	72,83
1900	74,80
1950	76,77
2000	78,74
2020	79,53
2030	79,92
* 2032	80,00
2060	81,10
2120	83,46
2150	84,65
2180	85,83
2240	88,19
2285	89,96
* 2330	91,73
2360	92,91
2410	94,88
2430	95,67
2500	98,43
2530	99,61
2540	100,00
2580	101,57
2600	102,36
2650	104,33
2680	105,51
2730	107,48
2760	108,66
2800	110,24
2840	111,81
* 2850	112,20
2900	114,17
2950	116,14
3000	118,11
3070	120,87
3082	121,34
3150	124,02
3170	124,80
3250	127,95
3320	130,71
3350	131,89
3400	133,86
3425	134,84
3450	135,83
3500	137,80
3550	139,76
3650	144,68
3750	147,64
3800	149,61
3825	150,59
3870	152,36
4000	157,48
4060	159,84
4120	162,20
4250	167,32
4310	169,68
4370	172,05
* 4400	173,23
4500	177,17
4560	179,53
4620	181,89
4750	187,01
4820	189,76
4870	191,73
5000	196,85
* 5070	199,61
5080	200,00

Section SPB / 5V

L _r (mm)	L _r (inch)
5300	208,66
5385	212,01
5600	220,47
5680	223,62
6000	236,22
6300	248,03
6700	263,78
7100	279,53
7500	295,28
8000	314,96

Section SPC

L _r (mm)	L _r (inch)
2000	78,74
2120	83,46
2240	88,19
2360	92,91
2500	98,43
2650	104,33
2800	110,24
3000	118,11
3150	124,02
3350	131,89
3500	137,80
3550	139,76
3750	147,64
4000	157,48
4100	161,42
4250	167,32
4380	172,44
* 4400	173,23
4500	177,17
4750	187,01
5000	196,85
5300	208,66
5440	214,17
* 5450	214,57
5600	220,47
6000	236,22
* 6050	238,19
6300	248,03
6700	263,78
7100	279,53
7500	295,28
8000	314,96
8500	334,65
9000	354,33
9500	374,02
10000	393,70
10600	417,32
11200	440,94
11800	464,57
12500	492,13
* 13800	543,31

Section 8V

L _r (mm)	L _r (inch)
8V 1000	
8V 1060	
8V 1120	
8V 1180	
8V 1250	
8V 1320	
8V 1400	
8V 1500	
8V 1600	

Section 8V

L _r (mm)	L _r (inch)
8V 1700	
8V 1800	
8V 1900	
8V 2000	
8V 2120	
8V 2240	
8V 2360	
8V 2500	
8V 2650	
8V 2800	
8V 3000	
8V 3150	
8V 3350	
8V 3550	
8V 3750	
8V 4000	
8V 4250	
8V 4500	
* 8V 4750	
* 8V 5000	

PROGRAM
11

ROFLEX-X Narrow Section Raw-Edge V-Belts

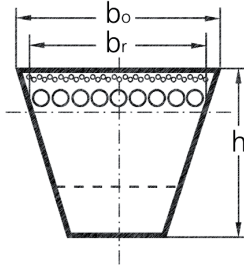

SECTION	ISO 4184, BS 3790 DIN 7753/1 RMA/MTPA IP-22	XPZ	XPA	XPB	XPC	3VX/9NX	5VX/ 15NX
Belt width (top)	b_o [mm] \approx	9,7	12,7	16,3	22	9	15
Datum width	b_r [mm]	8,5	11	14	19		
Belt thickness	h [mm] \approx	8	9	13	18	8	13
Datum length	$L_r \approx L_e$ - [mm]					4	11
Inner length	$L_i \approx L_r$ - [mm]	37	45	60	69		
Outer length	$L_a \approx L_r$ - [mm]	13	18	22	30		
Minimum datum pulley diameter	d_r [mm]	50	63	100	160		
Weight	[kg/m] \approx	0,065	0,105	0,190	0,325		
Maximum bending frequency	f [Hz]	120					
Recommended maximum belt speed	v [m/s]	50					

* On request

Section XPZ / 3VX

L_r (mm)	L_r (inch)
562	22,13
587	23,11
612	24,09
630	24,80 3VX 250
* 637	25,08
662	26,06 3VX 260
670	26,38 3VX 265
687	27,05
710	27,95 3VX 280
722	28,43
737	29,02
750	29,53
762	30,00 3VX 300
772	30,39
780	30,71
787	30,98
* 795	31,30
800	31,50 3VX 315
812	31,97
825	32,48
837	32,95
850	33,46 3VX 335
862	33,94
875	34,45
887	34,92 3VX 350
900	35,43 3VX 355
912	35,91
925	36,42
* 930	36,61
937	36,89
950	37,40 3VX 375
962	37,87
987	38,86
1000	39,37
1010	39,76 3VX 400
1012	39,84 3VX 400
* 1024	40,31
1037	40,83
* 1047	41,22
1060	41,73
* 1075	42,32
1077	42,40 3VX 425
1087	42,80
1112	43,78
1120	44,09
1137	44,76 3VX 450

Section XPZ / 3VX

L_r (mm)	L_r (inch)
1150	45,28
1162	45,75
1180	46,46
1187	46,73
1200	47,24 3VX 475
1202	47,32 3VX 475
1212	47,72
1237	48,70
1250	49,21
1262	49,68 3VX 500
1270	50,00
1287	50,67
1312	51,65
1320	51,97 3VX 520
1337	52,64 3VX 530
1340	52,76
* 1347	53,03
1362	53,62
* 1387	54,61
1400	55,12
1412	55,59
1420	55,91 3VX 560
1437	56,57
1450	57,09
1462	57,56
* 1470	57,87
1487	58,54
1500	59,06
1512	59,53
1520	59,84 3VX 600
1537	60,51
1562	61,50 3VX 617
1587	62,48
1600	62,99 3VX 630
* 1612	63,46
1637	64,45
1662	65,43
1687	66,42
1700	66,93 3VX 670
1737	68,39
1762	69,37
* 1787	70,35
1800	70,87 3VX 710
* 1812	71,34
* 1837	72,32
1850	72,83

Section XPZ / 3VX

L_r (mm)	L_r (inch)
1862	73,31
* 1887	74,29
1900	74,80 3VX 750
* 1937	76,26
1950	76,77
* 1987	78,23
2000	78,74
* 2025	79,72
2037	80,20 3VX 800
2120	83,46
* 2137	84,13
2160	85,04 3VX 850
* 2187	86,10
* 2240	88,19
* 2280	89,76
2287	90,04 3VX 900
* 2360	92,91
2410	94,88 3VX 950
* 2500	98,43
2540	100,00
2650	104,33
2685	105,71
* 2800	110,24
* 2840	111,81
* 3000	118,11 3VX 1180
* 3150	124,02 3VX 1250
* 3350	131,89 3VX 1320
* 3550	139,76 3VX 1400

Section XPA

L_r (mm)	L_r (inch)
950	37,40
* 957	37,68
* 967	38,07
975	38,39
982	38,66
1000	39,37
* 1007	39,65
1032	40,63
1060	41,73
1082	42,60
1090	42,91
1107	43,58
1120	44,09
* 1132	44,57
1150	45,28
1157	45,55
1180	46,46
1207	47,52
1232	48,50
1250	49,21
1257	49,49
* 1272	50,08
1282	50,47
1307	51,46
1320	51,97
1332	52,44
1357	53,43
1382	54,41
1400	55,12
* 1407	55,39
1432	56,38
1450	57,09
1457	57,36
1482	58,35
1500	59,06
1507	59,33
1532	60,31
1550	61,02
1557	61,30
1582	62,28
1600	62,99
* 1607	63,27
1632	64,25
1650	64,96
1657	65,24
1682	66,22

Section XPA

L_r (mm)	L_r (inch)
* 732	28,82
757	29,80
* 782	30,79
800	31,50
* 807	31,77
* 825	32,48
832	32,76
850	33,46
* 857	33,74
882	34,72
900	35,43
* 907	35,71
925	36,42
932	36,69

ROFLEX-X Narrow Section Raw-Edge V-Belts

Section XPA

L _r (mm)	L _r (inch)
1700	66,93
* 1732	68,19
1750	68,90
1757	69,17
1782	70,16
1800	70,87
* 1807	71,14
* 1832	72,13
1850	72,83
1857	73,11
* 1882	74,09
1900	74,80
* 1907	75,08
* 1932	76,06
1950	76,77
* 1957	77,05
* 1982	78,03
2000	78,74
* 2020	79,53
* 2032	80,00
2057	80,98
2082	81,97
2120	83,46
* 2132	83,94
2182	85,91
* 2207	86,89
2240	88,19
* 2282	89,84
2300	90,55
* 2307	90,83
* 2332	91,81
2360	92,91
* 2382	93,78
2432	95,75
* 2482	97,72
2500	98,43
* 2532	99,68
2582	101,65
* 2632	103,62
2650	104,33
* 2682	105,59
* 2732	107,56
* 2782	109,53
2800	110,24
* 2832	111,50
* 2847	112,09
* 2882	113,46
* 2932	115,43
* 2982	117,40
3000	118,11
* 3032	119,37
* 3082	121,34
3150	124,02
* 3182	125,28
* 3282	129,21
3350	131,89
* 3382	133,15
3550	139,76
3750	147,64
4000	157,48
* 4250	167,32
* 4500	177,17

Section XPB / 5VX

L _r (mm)	L _r (inch)
1250	49,21
1260	49,61 5VX 500
1320	51,97
1340	52,76 5VX 530
1400	55,12 5VX 560
1450	57,09
1500	59,06 5VX 600
1525	60,04
1550	61,02
1590	62,60
1600	62,99 5VX 630
1650	64,96
1700	66,93 5VX 670
1750	68,90
1800	70,87 5VX 710
1850	72,83
1900	74,80 5VX 750
1950	76,77
2000	78,74
2020	79,53 5VX 800
2120	83,46 5VX 840
2150	84,65 5VX 850
2180	85,83
2240	88,19
2285	89,96 5VX 900
* 2300	90,55
2360	92,91
* 2400	94,49
2410	94,88 5VX 950
* 2450	96,46
2500	98,43
2530	99,61 5VX 1000
* 2630	103,54
2650	104,33
2680	105,51 5VX 1060
2730	107,48 5VX 1080
2800	110,24
2840	111,81 5VX 1120
2900	114,17
3000	118,11 5VX 1180
3150	124,02 5VX 1250
3170	124,80
* 3210	126,38
3250	127,95
3350	131,89 5VX 1320
3550	139,76 5VX 1400
3750	147,64
3800	149,61 5VX 1500
4000	157,48
4060	159,84 5VX 1600
4250	167,32
* 4310	169,68 5VX 1700
4500	177,17
4750	187,01
* 4820	189,76 5VX 1900
5000	196,85

Section XPC

L _r (mm)	L _r (inch)
3150	124,02
3350	131,89
3550	139,76
3750	147,64
4000	157,48
4250	167,32
4500	177,17
4750	187,01
5000	196,85

Section XPC

L _r (mm)	L _r (inch)
2000	78,74
2120	83,46
2240	88,19
2360	92,91
2500	98,43
2650	104,33
2800	110,24
3000	118,11

ROFLEX RE-X Classical Section Raw-Edge V-Belts

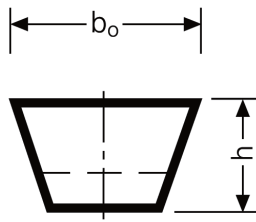

SECTION	ISO 4184, BS 3790 DIN 2215 ANSI/RMA IP-20	5/-	6/Y	8/-
Belt width (top)	b_o [mm] \approx	5	6	8
Datum width	b_r [mm]	4,2	5,3	6,7
Belt thickness	h [mm] \approx	3	4	5
Inner length	$L_i \approx L_r -$ [mm]	11	15	19
Outer length	$L_a \approx L_r +$ [mm]	8	10	12
Minimum datum pulley diameter	d_r [mm]	16	20	31,5
Weight	[kg/m] \approx	0,015	0,023	0,041
Maximum bending frequency	f [Hz]	120		
Recommended maximum belt speed	v [m/s]	50		

* On request
N: Plain version, non-cogged

Section 5/-

L_i (mm)	L_i (inch)
* 160	6,30
* N185	7,28
* N190	7,48
* N229	9,02
* N236	9,29
* N260	10,24
* N265	10,43
* 270	10,63
* 280	11,02
* N287	11,30
* 300	11,81
* N303	11,93
* 315	12,40
* 322	12,68
* N330	12,99
* 335	13,19
* 340	13,39
* N345	13,58
* N350	13,78
* 352	13,86
* N358	14,09
* 375	14,76
* 400	15,75
* N406	15,98
* N420	16,54
* 425	16,73
* N435	17,13
* N441	17,36
* 450	17,72
* N465	18,31
* N471	18,54
* N475	18,70
* N495	19,49
* N500	19,69
* N514	20,24
* 530	20,87
* N554	21,81
* 560	22,05
* 600	23,62

Section 6/Y

L_i (mm)	L_i (inch)
* N240	9,45
* N250	9,84
* N260	10,24
* N265	10,43
* 270	10,63
* 280	11,02
* 300	11,81
* 315	12,40
* N320	12,60
* N330	12,99
* 335	13,19
* 339	13,35
* N339	13,35
* N350	13,78
* 352	13,86
* N372	14,65
* 375	14,76
* N380	14,96
* 400	15,75
* 425	16,73
* 450	17,72
* 495	19,49
* N500	19,69
* 530	20,87
* N540	21,26
* N550	21,65
* 560	22,05
* N580	22,83
* 600	23,62
* N640	25,20
* 850	33,46
* N900	35,43

Section 8/-

L_i (mm)	L_i (inch)
* 160	6,30
* 280	11,02
* 300	11,81
* 315	12,40
* 322	12,68
* N335	13,19
* 340	13,39
* 355	13,98
* 375	14,76
* 400	15,75
* N430	16,93
* 450	17,72
* N475	18,70
* 495	19,49
* 530	20,87
* N560	22,05
* N580	22,83
* 600	23,62
* N630	24,80
* N655	25,79
* N670	26,38
* N680	26,77
* N700	27,56
* N710	27,95
* N717	28,23
* N750	29,53
* N800	31,50

ROFLEX Double-Sided V-Belts

Section HBB / BB

RMA	L _e (mm)	L _r (mm)	L _e (inch)	L _r (inch)
234 *	6013		236,73	
240 *	6155		242,32	
249 *	6392		251,65	
253 *	6495		255,71	
262 *	6724		264,72	
269 *	6902		271,73	
270 *	6930		272,83	
273 *	7003		275,71	

Section 25 x 22

RMA	L _e (mm)	L _r (mm)	L _e (inch)	L _r (inch)
2810 *		2871		113,03
3180 *		3241		127,60
3210 *		3271		128,78
3280 *		3341		131,54
4060 *		4121		162,24

Section HCC / CC

RMA	L _e (mm)	L _r (mm)	L _e (inch)	L _r (inch)
111 *	2921		115,00	
112 *	2946		115,98	
114 *	2997		117,99	
122 *	3200		125,98	
124 *	3250		127,95	
126 *	3301		129,96	
128 *	3352		131,97	
130 *	3400		133,86	
134 *	3505		137,99	
135	3530		138,98	
138	3606		141,97	
142	3708		145,98	
144	3759		147,99	
146	3809		149,96	
147	3834		150,94	
148	3860		151,97	
149	3886		152,99	
153 *	3987		156,97	
154 *	4013		157,99	
155 *	4037		158,94	
156 *	4063		159,96	
158	4114		161,97	
159 *	4140		162,99	
162	4216		165,98	
164 *	4267		167,99	
165 *	4292		168,98	
173	4495		176,97	
175	4546		178,98	
178	4622		181,97	
180	4673		183,98	
182 *	4724		185,98	
188 *	4876		191,97	
193 *	5003		196,97	
195	5054		198,98	
197 *	5105		200,98	
198	5130		201,97	
205 *	5308		208,98	
206 *	5333		209,96	
207 *	5359		210,98	
210	5435		213,98	
212	5485		215,94	
213 *	5511		216,97	
220	5691		224,05	
222 *	5740		225,98	
224 *	5791		227,99	
226	5841		229,96	
227	5867		230,98	
228	5892		231,97	
232 *	5994		235,98	
238 *	6146		241,97	
240 *	6197		243,98	
253	6533		257,20	
270	6960		274,02	

ROFLEX Banded V-Belts

Section 5V (15J)

RMA notation L _e (1/10 inch)	ISO notation L _e (mm)
5V 900	15J2286
5V 950	15J2413
5V 1000	15J2540
5V 1060	15J2692
5V 1120	15J2845
5V 1180	15J2997
5V 1250	15J3175
5V 1320	15J3353
5V 1400	15J3556
5V 1500	15J3810
5V 1600	15J4064
5V 1700	15J4318
5V 1800	15J4572
5V 1900	15J4826
5V 2000	15J5080
5V 2120	15J5385
5V 2240	15J5690
5V 2360	15J5994
5V 2500	15J6350
5V 2650	15J6731
5V 2800	15J7112
5V 3000	15J7620
5V 3150	15J8001
5V 3350	15J8509
5V 3550	15J9017

Section SPZ

L _w (mm)	L _w (inch)
* 900	35,43
* 912	35,91
* 925	36,42
* 937	36,89
* 950	37,40
* 987	38,86
* 1047	41,22
* 1112	43,78
* 1120	44,09
* 1137	44,76
* 1162	45,75
* 1180	46,46
* 1187	46,73
* 1202	47,32
* 1212	47,72
* 1237	48,70
* 1250	49,21
* 1262	49,68
* 1287	50,67
* 1312	51,65
* 1320	51,97
* 1337	52,64
* 1347	53,03
* 1362	53,62
* 1387	54,61
* 1400	55,12
* 1412	55,59
* 1437	56,57
* 1462	57,56
* 1487	58,54
* 1500	59,06
* 1512	59,53
* 1537	60,51
* 1562	61,50
* 1587	62,48
* 1600	62,99
* 1612	63,46
* 1637	64,45
* 1662	65,43
* 1687	66,42
* 1700	66,93
* 1737	68,39
* 1762	69,37
* 1787	70,35
* 1800	70,87
* 1812	71,34
* 1837	72,32
* 1862	73,31
* 1887	74,29
* 1900	74,80
* 1937	76,26
* 1987	78,23
* 2000	78,74
* 2037	80,20
* 2120	83,46
* 2137	84,13
* 2187	86,10
* 2240	88,19
* 2262	89,05
* 2287	90,04
* 2300	90,55
* 2360	92,91
* 2450	96,46
* 2500	98,43
* 2650	104,33
* 2800	110,24
* 3000	118,11
* 3150	124,02

Section SPZ

L _w (mm)	L _w (inch)
* 3350	131,89
* 3550	139,76

Section SPA

L _w (mm)	L _w (inch)
* 900	35,43
* 1000	39,37
* 1107	43,58
* 1132	44,57
* 1157	45,55
* 1180	46,46
* 1200	47,24
* 1232	48,50
* 1250	49,21
* 1272	50,08
* 1282	50,47
* 1300	51,18
* 1332	52,44
* 1357	53,43
* 1382	54,41
* 1400	55,12
* 1432	56,38
* 1457	57,36
* 1482	58,35
* 1500	59,06
* 1532	60,31
* 1557	61,30
* 1582	62,28
* 1600	62,99
* 1632	64,25
* 1657	65,24
* 1682	66,22
* 1700	66,93
* 1707	67,20
* 1732	68,19
* 1757	69,17
* 1782	70,16
* 1800	70,87
* 1832	72,13
* 1857	73,11
* 1882	74,09
* 1900	74,80
* 1932	76,06
* 1957	77,05
* 1982	78,03
* 2000	78,74
* 2032	80,00
* 2057	80,98
* 2082	81,97
* 2120	83,46
* 2132	83,94
* 2182	85,91
* 2207	86,89
* 2240	88,19
* 2282	89,84
* 2300	90,55
* 2332	91,81
* 2360	92,91
* 2382	93,78
* 2432	95,75
* 2482	97,72
* 2500	98,43
* 2532	99,68
* 2582	101,65
* 2607	102,64
* 2632	103,62
* 2650	104,33

Section 8V (25J)

RMA notation L _e (1/10 inch)	ISO notation L _e (mm)
* 8V 1000	25J2540
* 8V 1060	25J2692
* 8V 1120	25J2845
* 8V 1180	25J2997
* 8V 1250	25J3175
* 8V 1320	25J3353
* 8V 1400	25J3556
* 8V 1500	25J3810
* 8V 1600	25J4064
* 8V 1700	25J4318
* 8V 1800	25J4572
* 8V 1900	25J4826
* 8V 2000	25J5080
* 8V 2120	25J5383
* 8V 2240	25J5690
* 8V 2360	25J5994
* 8V 2500	25J6350
* 8V 2650	25J6731
* 8V 2800	25J7112
* 8V 3000	25J7620
* 8V 3150	25J8001
* 8V 3350	25J8509
* 8V 3550	25J9017
* 8V 3750	25J9525
* 8V 4000	25J10160
* 8V 4250	25J10795
* 8V 4500	25J11430
* 8V 4750	25J12065
* 8V 5000	25J12700
* 8V 5600	25J14224
* 8V 6000	25J15240
* 8V 6300	25J16002

ROFLEX Banded V-Belts

Section SPA

L _w (mm)	L _w (inch)
* 2682	105,59
* 2732	107,56
* 2782	109,53
* 2800	110,24
* 2832	111,50
* 2847	112,09
* 2882	113,46
* 2932	115,43
* 3000	118,11
* 3032	119,37
* 3082	121,34
* 3150	124,02
* 3182	125,28
* 3282	129,21
* 3350	131,89
* 3382	133,15
* 3550	139,76
* 3750	147,64
* 4000	157,48
* 4250	167,32
* 4500	177,17

Section SPC

L _w (mm)	L _w (inch)
5300	208,66
5600	220,47
6000	236,22
6300	248,03
6700	263,78
7100	279,53
* 7500	295,28
8000	314,96
* 8500	334,65
* 9000	354,33
9500	374,02
* 10000	393,70
* 10600	417,32
* 11200	440,94
* 11800	464,57
* 12500	492,13

Section SPB

L _w (mm)	L _w (inch)
2000	78,74
2100	82,68
2240	88,19
2360	92,91
2500	98,43
2650	104,33
2800	110,24
3000	118,11
3150	124,02
3350	131,89
3550	139,76
3750	147,64
4000	157,48
4250	167,32
4500	177,17
4750	187,01
5000	196,85
5300	208,66
5600	220,47
6000	236,22
* 6300	248,03
* 6700	263,78
* 7100	279,53
* 7500	295,28
* 8000	314,96
* 9500	374,02
* 10000	393,70

Section SPC

L _w (mm)	L _w (inch)
* 2650	104,33
* 2800	110,24
* 3000	118,11
* 3150	124,02
3350	131,89
3550	139,76
3750	147,64
4000	157,48
4250	167,32
4500	177,17
4750	187,01
5000	196,85

ROFLEX Multiribbed Belts

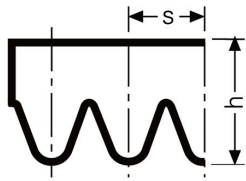

SECTION	ASAE S 211.4/ANSI/RMA IP-20, RMA/MPTA IP-22	PJ	PK	PL	PM
Rib pitch	S [mm]	2,34	3,56	4,7	9,4
Belt thickness	h [mm] ≈	3,8	5,0	9,0	14,5
Minimum effective diameter of smallest pulley	d _d [mm]	20	45	75	180
Recommended maximum belt speed	v [m/s]	60	50	40	35

* On request

Section PJ

L _b (mm)	L _b (1/10 inch)
* 330	130
356	140
381	150
406	160
432	170
457	180
483	190
508	200
559	220
584	230
610	240
660	260
* 675	266
686	270
* 704	277
711	280
* 723	285
737	290
762	300
* 782	308
787	310
* 792	311
* 797	314
813	320
838	330
864	340
889	350
* 895	352
914	360
* 955	376
* 958	377
965	380
* 985	388
991	390
* 1000	394
1016	400
* 1040	409
1054	415
* 1059	416
* 1065	419
1092	430
* 1105	435
* 1117	440
* 1130	445
* 1136	447
1143	450
* 1151	453
1168	460
* 1173	462
1194	470
1200	472
1208	476

Section PJ

L _b (mm)	L _b (1/10 inch)
1219	480
1245	490
* 1251	492
1270	500
* 1280	504
* 1287	507
1295	510
1321	520
* 1325	522
1333	525
* 1340	528
1372	540
1397	550
* 1428	562
1461	575
* 1466	577
1473	580
* 1520	598
1549	610
1600	630
1626	640
1651	650
1702	670
1753	690
1778	700
1854	730
* 1885	742
1915	754
1930	760
1956	770
1981	780
* 1992	784
2019	795
* 2070	815
2083	820
* 2134	840
2210	870
2286	900
2337	920
2489	980

Section PK

L _b (mm)	L _b (1/10 inch)
635	250
648	255
698	275
730	287
813	320
830	326
885	348
925	364

Section PK

L _b (mm)	L _b (1/10 inch)
960	378
1010	397
1035	407
1132	445
* 1173	462
1207	475
1246	490
1298	511
1357	534
1420	559
1459	574
1481	583
1521	598
1607	632
1630	641
1675	659
1725	679
1815	714
* 1860	732
1885	741
1982	780
2031	799
2080	818
2171	854
2225	875
2471	972
2551	1003

Section PL

L _b (mm)	L _b (1/10 inch)
1295	510
1321	520
1333	525
1346	530
1372	540
1397	550
1422	560
1435	565
* 1466	577
1473	580
1499	590
* 1520	598
1562	615
1613	635
1651	650
1664	655
1715	675
1765	695
1803	710
1841	725
1943	765
1956	770
1981	780
2019	795
2070	815
2095	825
2134	840
2195	865
2235	880
2324	915
2362	930
2477	975
2515	990
2705	1065
2745	1080
2845	1120
2895	1140
2921	1150
2997	1180
3085	1215
3124	1230
3289	1295
3327	1310
3492	1375
3696	1455
4051	1595
4191	1650
4318	1700
4470	1760
4622	1820
5029	1980
5385	2120

Section PL

L _b (mm)	L _b (1/10 inch)
* 675	266
* 698	275
* 723	285
* 762	300
* 794	313
* 840	331
* 880	346
* 954	376
991	390
1041	410
* 1075	423
* 1080	425
* 1092	430
* 1098	432
1149	452
* 1163	458
1168	460
1194	470
1219	480
* 1237	487
1270	500

ROFLEX Multiribbed Belts

Section PL

L_b (mm)	L_b (1/10 inch)
6096	2400
7055	2777

Section PM

L_b (mm)	L_b (1/10 inch)
2286	900
2388	940
2515	990
2693	1060
2832	1115
2921	1150
3010	1185
3124	1230
3327	1310
3531	1390
3734	1470
4089	1610
4191	1650
4470	1760
4648	1830
5029	1980
5410	2130
6121	2410
6883	2710
7646	3010
8408	3310
9169	3610
9931	3910
10693	4210
12217	4810
13741	5410
15266	6010
16764	6600

RO-DRIVE Synchronous Belts

Section S8M STD

Section	L _w (mm)	L _w (inch)	z
992 - S8M	992	39,06	124
1000 - S8M	1000	39,37	125
* 1016 - S8M	1016	40,00	127
* 1024 - S8M	1024	40,31	128
* 1032 - S8M	1032	40,63	129
1056 - S8M	1056	41,57	132
1064 - S8M	1064	41,89	133
1072 - S8M	1072	42,20	134
* 1080 - S8M	1080	42,52	135
* 1096 - S8M	1096	43,15	137
* 1104 - S8M	1104	43,46	138
1120 - S8M	1120	44,09	140
1136 - S8M	1136	44,72	142
* 1152 - S8M	1152	45,35	144
1160 - S8M	1160	45,67	145
1168 - S8M	1168	45,98	146
1176 - S8M	1176	46,30	147
1184 - S8M	1184	46,61	148
* 1192 - S8M	1192	46,93	149
1200 - S8M	1200	47,24	150
* 1208 - S8M	1208	47,56	151
1216 - S8M	1216	47,87	152
* 1224 - S8M	1224	48,19	153
1240 - S8M	1240	48,82	155
1256 - S8M	1256	49,45	157
1264 - S8M	1264	49,76	158
1280 - S8M	1280	50,39	160
1296 - S8M	1296	51,02	162
1304 - S8M	1304	51,34	163
1312 - S8M	1312	51,65	164
1344 - S8M	1344	52,91	168
* 1352 - S8M	1352	53,23	169
1368 - S8M	1368	53,86	171
1400 - S8M	1400	55,12	175
1408 - S8M	1408	55,43	176
* 1432 - S8M	1432	56,38	179
1440 - S8M	1440	56,69	180
1480 - S8M	1480	58,27	185
1512 - S8M	1512	59,53	189
* 1520 - S8M	1520	59,84	190
* 1536 - S8M	1536	60,47	192
* 1544 - S8M	1544	60,79	193
1552 - S8M	1552	61,10	194
1600 - S8M	1600	62,99	200
1624 - S8M	1624	63,94	203
1760 - S8M	1760	69,29	220
1776 - S8M	1776	69,92	222
1800 - S8M	1800	70,87	225
1816 - S8M	1816	71,50	227
1912 - S8M	1912	75,28	239
* 2000 - S8M	2000	78,74	250
* 2024 - S8M	2024	79,68	253
2240 - S8M	2240	88,19	280
* 2272 - S8M	2272	89,45	284
2392 - S8M	2392	94,17	299
2800 - S8M	2800	110,24	350
2848 - S8M	2848	112,13	356

RO-DRIVE TORQUE Synchronous Belts

8M HTD
14M HTD

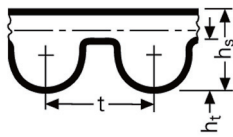

SECTION		8M HTD	14M HTD
Tooth pitch	t [mm]	8	14
Belt thickness	h_s [mm]	5,60	10,00
Tooth height	h_t [mm]	3,40	6,10

* On request

Section 8M HTD

Section	L_w (mm)	L_w (inch)	z
* 288 - 8M TORQUE	288,00	11,34	36
* 304 - 8M TORQUE	304,00	11,97	38
* 352 - 8M TORQUE	352,00	13,86	44
376 - 8M TORQUE	376,00	14,80	47
* 416 - 8M TORQUE	416,00	16,38	52
* 424 - 8M TORQUE	424,00	16,69	53
472 - 8M TORQUE	472,00	18,58	59
480 - 8M TORQUE	480,00	18,90	60
560 - 8M TORQUE	560,00	22,05	70
600 - 8M TORQUE	600,00	23,62	75
624 - 8M TORQUE	624,00	24,57	78
640 - 8M TORQUE	640,00	25,20	80
656 - 8M TORQUE	656,00	25,83	82
720 - 8M TORQUE	720,00	28,35	90
776 - 8M TORQUE	776,00	30,55	97
784 - 8M TORQUE	784,00	30,87	98
800 - 8M TORQUE	800,00	31,50	100
880 - 8M TORQUE	880,00	34,65	110
912 - 8M TORQUE	912,00	35,91	114
920 - 8M TORQUE	920,00	36,22	115
960 - 8M TORQUE	960,00	37,80	120
1040 - 8M TORQUE	1040,00	40,94	130
1120 - 8M TORQUE	1120,00	44,09	140
1200 - 8M TORQUE	1200,00	47,24	150
1280 - 8M TORQUE	1280,00	50,39	160
1304 - 8M TORQUE	1304,00	51,34	163
1328 - 8M TORQUE	1328,00	52,28	166
1360 - 8M TORQUE	1360,00	53,54	170
1424 - 8M TORQUE	1424,00	56,06	178
1440 - 8M TORQUE	1440,00	56,69	180
1600 - 8M TORQUE	1600,00	62,99	200
1760 - 8M TORQUE	1760,00	69,29	220
1800 - 8M TORQUE	1800,00	70,87	225
2000 - 8M TORQUE	2000,00	78,74	250
2248 - 8M TORQUE	2248,00	88,50	281
2400 - 8M TORQUE	2400,00	94,49	300
2800 - 8M TORQUE	2800,00	110,24	350
* 3008 - 8M TORQUE	3008,00	118,42	376
* 3408 - 8M TORQUE	3408,00	134,17	426
* 3808 - 8M TORQUE	3808,00	149,92	476

Section 14M HTD

Section	L_w (mm)	L_w (inch)	z
966 - 14M TORQUE	966,00	38,03	69
1190 - 14M TORQUE	1190,00	46,85	85
1400 - 14M TORQUE	1400,00	55,12	100
1610 - 14M TORQUE	1610,00	63,39	115
1778 - 14M TORQUE	1778,00	70,00	127
1890 - 14M TORQUE	1890,00	74,41	135
2100 - 14M TORQUE	2100,00	82,68	150
2310 - 14M TORQUE	2310,00	90,94	165
2450 - 14M TORQUE	2450,00	96,46	175
2590 - 14M TORQUE	2590,00	101,97	185
2800 - 14M TORQUE	2800,00	110,24	200
3150 - 14M TORQUE	3150,00	124,02	225
3500 - 14M TORQUE	3500,00	137,80	250
3850 - 14M TORQUE	3850,00	151,57	275
4326 - 14M TORQUE	4326,00	170,31	309
4578 - 14M TORQUE	4578,00	180,24	327

RO-DRIVE PLUS Synchronous Belts

3M HTD
5M HTD
8M HTD
14M HTD

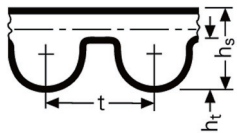

S8M STD

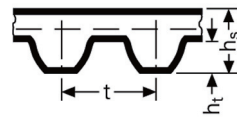

SECTION		3M HTD	5M HTD	8M HTD	14M HTD	S8M STD
Tooth pitch	t [mm]	3	5	8	14	8
Belt thickness	h _s [mm]	2,40	3,60	5,60	10,00	5,30
Tooth height	h _t [mm]	1,20	2,10	3,40	6,10	2,95

* On request

Section 3M HTD

Section	L _w (mm)	L _w (inch)	z
* 111 - 3M PLUS	111,00	4,37	37
* 117 - 3M PLUS	117,00	4,61	39
* 129 - 3M PLUS	129,00	5,08	43
* 141 - 3M PLUS	141,00	5,55	47
* 144 - 3M PLUS	144,00	5,67	48
150 - 3M PLUS	150,00	5,91	50
* 156 - 3M PLUS	156,00	6,14	52
* 159 - 3M PLUS	159,00	6,26	53
* 168 - 3M PLUS	168,00	6,61	56
* 174 - 3M PLUS	174,00	6,85	58
* 177 - 3M PLUS	177,00	6,97	59
180 - 3M PLUS	180,00	7,09	60
* 186 - 3M PLUS	186,00	7,32	62
* 192 - 3M PLUS	192,00	7,56	64
* 201 - 3M PLUS	201,00	7,91	67
* 204 - 3M PLUS	204,00	8,03	68
* 210 - 3M PLUS	210,00	8,27	70
* 213 - 3M PLUS	213,00	8,39	71
216 - 3M PLUS	216,00	8,50	72
225 - 3M PLUS	225,00	8,86	75
* 240 - 3M PLUS	240,00	9,45	80
246 - 3M PLUS	246,00	9,69	82
* 252 - 3M PLUS	252,00	9,92	84
* 255 - 3M PLUS	255,00	10,04	85
* 267 - 3M PLUS	267,00	10,51	89
* 285 - 3M PLUS	285,00	11,22	95
* 294 - 3M PLUS	294,00	11,57	98
* 300 - 3M PLUS	300,00	11,81	100
* 312 - 3M PLUS	312,00	12,28	104
* 318 - 3M PLUS	318,00	12,52	106
* 336 - 3M PLUS	336,00	13,23	112
* 339 - 3M PLUS	339,00	13,35	113
* 363 - 3M PLUS	363,00	14,29	121
* 384 - 3M PLUS	384,00	15,12	128
* 390 - 3M PLUS	390,00	15,35	130
* 393 - 3M PLUS	393,00	15,47	131
* 420 - 3M PLUS	420,00	16,54	140
* 447 - 3M PLUS	447,00	17,60	149
* 474 - 3M PLUS	474,00	18,66	158
* 480 - 3M PLUS	480,00	18,90	160
* 486 - 3M PLUS	486,00	19,13	162
* 489 - 3M PLUS	489,00	19,25	163
* 495 - 3M PLUS	495,00	19,49	165
* 501 - 3M PLUS	501,00	19,72	167
* 513 - 3M PLUS	513,00	20,20	171
* 522 - 3M PLUS	522,00	20,55	174
* 525 - 3M PLUS	525,00	20,67	175
* 537 - 3M PLUS	537,00	21,14	179
* 564 - 3M PLUS	564,00	22,20	188
* 570 - 3M PLUS	570,00	22,44	190
* 597 - 3M PLUS	597,00	23,50	199
* 600 - 3M PLUS	600,00	23,62	200
* 606 - 3M PLUS	606,00	23,86	202
* 612 - 3M PLUS	612,00	24,09	204

Section 3M HTD

Section	L _w (mm)	L _w (inch)	z
* 633 - 3M PLUS	633,00	24,92	211
* 669 - 3M PLUS	669,00	26,34	223
* 708 - 3M PLUS	708,00	27,87	236
* 711 - 3M PLUS	711,00	27,99	237
* 738 - 3M PLUS	738,00	29,06	246
* 753 - 3M PLUS	753,00	29,65	251
* 822 - 3M PLUS	822,00	32,36	274
* 843 - 3M PLUS	843,00	33,19	281
* 882 - 3M PLUS	882,00	34,72	294
* 945 - 3M PLUS	945,00	37,20	315
* 960 - 3M PLUS	960,00	37,80	320
* 1041 - 3M PLUS	1041,00	40,98	347
* 1068 - 3M PLUS	1068,00	42,05	356
* 1071 - 3M PLUS	1071,00	42,17	357
* 1125 - 3M PLUS	1125,00	44,29	375
* 1176 - 3M PLUS	1176,00	46,30	392
* 1245 - 3M PLUS	1245,00	49,02	415
* 1569 - 3M PLUS	1569,00	61,77	523

Section 5M HTD

Section	L _w (mm)	L _w (inch)	z
225 - 5M PLUS	225,00	8,86	45
265 - 5M PLUS	265,00	10,43	53
275 - 5M PLUS	275,00	10,83	55
295 - 5M PLUS	295,00	11,61	59
300 - 5M PLUS	300,00	11,81	60
330 - 5M PLUS	330,00	12,99	66
350 - 5M PLUS	350,00	13,78	70
375 - 5M PLUS	375,00	14,76	75
400 - 5M PLUS	400,00	15,75	80
425 - 5M PLUS	425,00	16,73	85
450 - 5M PLUS	450,00	17,72	90
460 - 5M PLUS	460,00	18,11	92
475 - 5M PLUS	475,00	18,70	95
500 - 5M PLUS	500,00	19,69	100
525 - 5M PLUS	525,00	20,67	105
535 - 5M PLUS	535,00	21,06	107
550 - 5M PLUS	550,00	21,65	110
565 - 5M PLUS	565,00	22,24	113
600 - 5M PLUS	600,00	23,62	120
615 - 5M PLUS	615,00	24,21	123
620 - 5M PLUS	620,00	24,41	124
630 - 5M PLUS	630,00	24,80	126
635 - 5M PLUS	635,00	25,00	127
665 - 5M PLUS	665,00	26,18	133
700 - 5M PLUS	700,00	27,56	140
710 - 5M PLUS	710,00	27,95	142
740 - 5M PLUS	740,00	29,13	148
755 - 5M PLUS	755,00	29,72	151
800 - 5M PLUS	800,00	31,50	160
835 - 5M PLUS	835,00	32,87	167
840 - 5M PLUS	840,00	33,07	168
860 - 5M PLUS	860,00	33,86	172

RO-DRIVE PLUS Synchronous Belts

Section 5M HTD

Section	L _w (mm)	L _w (inch)	z
890 - 5M PLUS	890,00	35,04	178
900 - 5M PLUS	900,00	35,43	180
925 - 5M PLUS	925,00	36,42	185
* 950 - 5M PLUS	950,00	37,40	190
1000 - 5M PLUS	1000,00	39,37	200
1050 - 5M PLUS	1050,00	41,34	210
1125 - 5M PLUS	1125,00	44,29	225
1200 - 5M PLUS	1200,00	47,24	240
1270 - 5M PLUS	1270,00	50,00	254
1500 - 5M PLUS	1500,00	59,06	300
1595 - 5M PLUS	1595,00	62,80	319
1690 - 5M PLUS	1690,00	66,54	338
1790 - 5M PLUS	1790,00	70,47	358
1800 - 5M PLUS	1800,00	70,87	360
2000 - 5M PLUS	2000,00	78,74	400

Section 14M HTD

Section	L _w (mm)	L _w (inch)	z
1890 - 14M PLUS	1890,00	74,41	135
2100 - 14M PLUS	2100,00	82,68	150
2310 - 14M PLUS	2310,00	90,94	165
2450 - 14M PLUS	2450,00	96,46	175
2590 - 14M PLUS	2590,00	101,97	185
2800 - 14M PLUS	2800,00	110,24	200
3150 - 14M PLUS	3150,00	124,02	225
3500 - 14M PLUS	3500,00	137,80	250
3850 - 14M PLUS	3850,00	151,57	275
4326 - 14M PLUS	4326,00	170,31	309
4578 - 14M PLUS	4578,00	180,24	327

Section 8M HTD

Section	L _w (mm)	L _w (inch)	z
288 - 8M PLUS	288,00	11,34	36
304 - 8M PLUS	304,00	11,97	38
352 - 8M PLUS	352,00	13,86	44
376 - 8M PLUS	376,00	14,80	47
416 - 8M PLUS	416,00	16,38	52
424 - 8M PLUS	424,00	16,69	53
472 - 8M PLUS	472,00	18,58	59
480 - 8M PLUS	480,00	18,90	60
560 - 8M PLUS	560,00	22,05	70
600 - 8M PLUS	600,00	23,62	75
624 - 8M PLUS	624,00	24,57	78
640 - 8M PLUS	640,00	25,20	80
656 - 8M PLUS	656,00	25,83	82
720 - 8M PLUS	720,00	28,35	90
776 - 8M PLUS	776,00	30,55	97
784 - 8M PLUS	784,00	30,87	98
800 - 8M PLUS	800,00	31,50	100
880 - 8M PLUS	880,00	34,65	110
912 - 8M PLUS	912,00	35,91	114
920 - 8M PLUS	920,00	36,22	115
960 - 8M PLUS	960,00	37,80	120
1040 - 8M PLUS	1040,00	40,94	130
1120 - 8M PLUS	1120,00	44,09	140
1200 - 8M PLUS	1200,00	47,24	150
1280 - 8M PLUS	1280,00	50,39	160
1304 - 8M PLUS	1304,00	51,34	163
1328 - 8M PLUS	1328,00	52,28	166
1360 - 8M PLUS	1360,00	53,54	170
1424 - 8M PLUS	1424,00	56,06	178
1440 - 8M PLUS	1440,00	56,69	180
1600 - 8M PLUS	1600,00	62,99	200
1760 - 8M PLUS	1760,00	69,29	220
1800 - 8M PLUS	1800,00	70,87	225
2000 - 8M PLUS	2000,00	78,74	250
2248 - 8M PLUS	2248,00	88,50	281
2400 - 8M PLUS	2400,00	94,49	300
2800 - 8M PLUS	2800,00	110,24	350
* 3008 - 8M PLUS	3008,00	118,42	376
* 3408 - 8M PLUS	3408,00	134,17	426
* 3808 - 8M PLUS	3808,00	149,92	476

Section S8M STD

Section	L _w (mm)	L _w (inch)	z
440 - S8M PLUS	440,00	17,32	55
480 - S8M PLUS	480,00	18,90	60
528 - S8M PLUS	528,00	20,79	66
560 - S8M PLUS	560,00	22,05	70
600 - S8M PLUS	600,00	23,62	75
632 - S8M PLUS	632,00	24,88	79
640 - S8M PLUS	640,00	25,20	80
656 - S8M PLUS	656,00	25,83	82
672 - S8M PLUS	672,00	26,46	84
688 - S8M PLUS	688,00	27,09	86
696 - S8M PLUS	696,00	27,40	87
712 - S8M PLUS	712,00	28,03	89
720 - S8M PLUS	720,00	28,35	90
728 - S8M PLUS	728,00	28,66	91
736 - S8M PLUS	736,00	28,98	92
760 - S8M PLUS	760,00	29,92	95
768 - S8M PLUS	768,00	30,24	96
784 - S8M PLUS	784,00	30,87	98
792 - S8M PLUS	792,00	31,18	99
800 - S8M PLUS	800,00	31,50	100
824 - S8M PLUS	824,00	32,44	103
848 - S8M PLUS	848,00	33,39	106
864 - S8M PLUS	864,00	34,02	108
880 - S8M PLUS	880,00	34,65	110
912 - S8M PLUS	912,00	35,91	114
920 - S8M PLUS	920,00	36,22	115
944 - S8M PLUS	944,00	37,17	118
960 - S8M PLUS	960,00	37,80	120
992 - S8M PLUS	992,00	39,06	124
1000 - S8M PLUS	1000,00	39,37	125
1056 - S8M PLUS	1056,00	41,57	132
1064 - S8M PLUS	1064,00	41,89	133
1072 - S8M PLUS	1072,00	42,20	134
1120 - S8M PLUS	1120,00	44,09	140
1136 - S8M PLUS	1136,00	44,72	142
1160 - S8M PLUS	1160,00	45,67	145
1168 - S8M PLUS	1168,00	45,98	146
1176 - S8M PLUS	1176,00	46,30	147
1184 - S8M PLUS	1184,00	46,61	148
1200 - S8M PLUS	1200,00	47,24	150
1216 - S8M PLUS	1216,00	47,87	152
1240 - S8M PLUS	1240,00	48,82	155
1256 - S8M PLUS	1256,00	49,45	157
1264 - S8M PLUS	1264,00	49,76	158
1280 - S8M PLUS	1280,00	50,39	160
1296 - S8M PLUS	1296,00	51,02	162
1304 - S8M PLUS	1304,00	51,34	163
1312 - S8M PLUS	1312,00	51,65	164
1344 - S8M PLUS	1344,00	52,91	168
1368 - S8M PLUS	1368,00	53,86	171
1400 - S8M PLUS	1400,00	55,12	175
1408 - S8M PLUS	1408,00	55,43	176
1440 - S8M PLUS	1440,00	56,69	180

Section 14M HTD

Section	L _w (mm)	L _w (inch)	z
966 - 14M PLUS	966,00	38,03	69
1190 - 14M PLUS	1190,00	46,85	85
1400 - 14M PLUS	1400,00	55,12	100
1610 - 14M PLUS	1610,00	63,39	115
1778 - 14M PLUS	1778,00	70,00	127

PROGRAM 34

RO-DRIVE PLUS Synchronous Belts

Section S8M STD

Section	L _w (mm)	L _w (inch)	z
1480 - S8M PLUS	1480,00	58,27	185
1512 - S8M PLUS	1512,00	59,53	189
1552 - S8M PLUS	1552,00	61,10	194
1600 - S8M PLUS	1600,00	62,99	200
1624 - S8M PLUS	1624,00	63,94	203
1760 - S8M PLUS	1760,00	69,29	220
1776 - S8M PLUS	1776,00	69,92	222
1800 - S8M PLUS	1800,00	70,87	225
1816 - S8M PLUS	1816,00	71,50	227
1912 - S8M PLUS	1912,00	75,28	239
2240 - S8M PLUS	2240,00	88,19	280
2392 - S8M PLUS	2392,00	94,17	299
2800 - S8M PLUS	2800,00	110,24	350
2848 - S8M PLUS	2848,00	112,13	356

RO-DRIVE TWIN PLUS Double-Sided Synchronous Belts

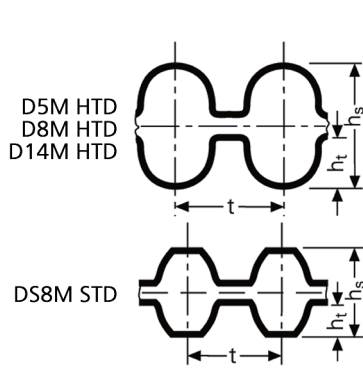

SECTION		5M HTD	8M HTD	14M HTD	S8M STD
Tooth pitch	t [mm]	5	8	14	8
Tooth height	h _t [mm]	2,10	3,40	6,10	3,00
Belt thickness	h _s [mm]	5,40	8,20	15,20	7,30

* On request

Section D5M DHTD

Section	L _w (mm)	L _w (inch)	z
* 565 - D5M PLUS	565,00	22,24	113
* 600 - D5M PLUS	600,00	23,62	120
* 615 - D5M PLUS	615,00	24,21	123
* 620 - D5M PLUS	620,00	24,41	124
* 630 - D5M PLUS	630,00	24,80	126
* 635 - D5M PLUS	635,00	25,00	127
* 665 - D5M PLUS	665,00	26,18	133
* 700 - D5M PLUS	700,00	27,56	140
* 710 - D5M PLUS	710,00	27,95	142
* 740 - D5M PLUS	740,00	29,13	148
* 755 - D5M PLUS	755,00	29,72	151
* 800 - D5M PLUS	800,00	31,50	160
* 835 - D5M PLUS	835,00	32,87	167
* 840 - D5M PLUS	840,00	33,07	168
* 860 - D5M PLUS	860,00	33,86	172
* 890 - D5M PLUS	890,00	35,04	178
* 900 - D5M PLUS	900,00	35,43	180
* 925 - D5M PLUS	925,00	36,42	185
* 1000 - D5M PLUS	1000,00	39,37	200
* 1050 - D5M PLUS	1050,00	41,34	210
* 1125 - D5M PLUS	1125,00	44,29	225
* 1200 - D5M PLUS	1200,00	47,24	240
* 1270 - D5M PLUS	1270,00	50,00	254
* 1420 - D5M PLUS	1420,00	55,91	284
* 1500 - D5M PLUS	1500,00	59,06	300
* 1595 - D5M PLUS	1595,00	62,80	319
* 1690 - D5M PLUS	1690,00	66,54	338
* 2000 - D5M PLUS	2000,00	78,74	400

Section D8M DHTD

Section	L _w (mm)	L _w (inch)	z
* 600 - D8M PLUS	600,00	23,62	75
* 624 - D8M PLUS	624,00	24,57	78
* 640 - D8M PLUS	640,00	25,20	80
* 656 - D8M PLUS	656,00	25,83	82
* 720 - D8M PLUS	720,00	28,35	90
* 776 - D8M PLUS	776,00	30,55	97
* 784 - D8M PLUS	784,00	30,87	98
* 800 - D8M PLUS	800,00	31,50	100
* 880 - D8M PLUS	880,00	34,65	110
* 912 - D8M PLUS	912,00	35,91	114
* 920 - D8M PLUS	920,00	36,22	115
* 960 - D8M PLUS	960,00	37,80	120
* 1040 - D8M PLUS	1040,00	40,94	130
* 1120 - D8M PLUS	1120,00	44,09	140
* 1200 - D8M PLUS	1200,00	47,24	150
* 1280 - D8M PLUS	1280,00	50,39	160
* 1304 - D8M PLUS	1304,00	51,34	163
* 1328 - D8M PLUS	1328,00	52,28	166
* 1360 - D8M PLUS	1360,00	53,54	170
* 1424 - D8M PLUS	1424,00	56,06	178

Section D8M DHTD

Section	L _w (mm)	L _w (inch)	z
* 1440 - D8M PLUS	1440,00	56,69	180
* 1600 - D8M PLUS	1600,00	62,99	200
* 1760 - D8M PLUS	1760,00	69,29	220
* 1800 - D8M PLUS	1800,00	70,87	225
* 2000 - D8M PLUS	2000,00	78,74	250
* 2248 - D8M PLUS	2248,00	88,50	281
* 2400 - D8M PLUS	2400,00	94,49	311
* 2600 - D8M PLUS	2600,00	102,36	325

Section D14M DHTD

Section	L _w (mm)	L _w (inch)	z
* 966 - D14M PLUS	966	38,03	69
* 1190 - D14M PLUS	1190	46,85	85
* 1400 - D14M PLUS	1400	55,12	100
* 1610 - D14M PLUS	1610	63,39	115
* 1778 - D14M PLUS	1778	70,00	127
* 1890 - D14M PLUS	1890	74,41	135
* 2100 - D14M PLUS	2100	82,68	150
* 2310 - D14M PLUS	2310	90,94	165

Section DS8M DSTD

Section	L _w (mm)	L _w (inch)	z
* 600 - DS8M PLUS	600,00	23,62	75
* 632 - DS8M PLUS	632,00	24,88	79
* 640 - DS8M PLUS	640,00	25,20	80
* 656 - DS8M PLUS	656,00	25,83	82
* 672 - DS8M PLUS	672,00	26,46	84
* 688 - DS8M PLUS	688,00	27,09	86
* 696 - DS8M PLUS	696,00	27,40	87
* 712 - DS8M PLUS	712,00	28,03	89
* 720 - DS8M PLUS	720,00	28,35	90
* 728 - DS8M PLUS	728,00	28,66	91
* 736 - DS8M PLUS	736,00	28,98	92
* 760 - DS8M PLUS	760,00	29,92	95
* 768 - DS8M PLUS	768,00	30,24	96
* 784 - DS8M PLUS	784,00	30,87	98
* 792 - DS8M PLUS	792,00	31,18	99
* 800 - DS8M PLUS	800,00	31,50	100
* 824 - DS8M PLUS	824,00	32,44	103
* 848 - DS8M PLUS	848,00	33,39	106
* 864 - DS8M PLUS	864,00	34,02	108
* 880 - DS8M PLUS	880,00	34,65	110
* 912 - DS8M PLUS	912,00	35,91	114
* 920 - DS8M PLUS	920,00	36,22	115
* 944 - DS8M PLUS	944,00	37,17	118
* 960 - DS8M PLUS	960,00	37,80	120
* 992 - DS8M PLUS	992,00	39,06	124
* 1000 - DS8M PLUS	1000,00	39,37	125
* 1056 - DS8M PLUS	1056,00	41,57	132
* 1064 - DS8M PLUS	1064,00	41,89	133

RO-DRIVE TWIN PLUS Double-Sided Synchronous Belts

Section DS8M DSTD

Section	L _w (mm)	L _w (inch)	z
* 1072 - DS8M PLUS	1072,00	42,20	134
* 1120 - DS8M PLUS	1120,00	44,09	140
* 1136 - DS8M PLUS	1136,00	44,72	142
* 1160 - DS8M PLUS	1160,00	45,67	145
* 1168 - DS8M PLUS	1168,00	45,98	146
* 1176 - DS8M PLUS	1176,00	46,30	147
* 1184 - DS8M PLUS	1184,00	46,61	148
* 1200 - DS8M PLUS	1200,00	47,24	150
* 1216 - DS8M PLUS	1216,00	47,87	152
* 1240 - DS8M PLUS	1240,00	48,82	155
* 1256 - DS8M PLUS	1256,00	49,45	157
* 1264 - DS8M PLUS	1264,00	49,76	158
* 1280 - DS8M PLUS	1280,00	50,39	160
* 1296 - DS8M PLUS	1296,00	51,02	162
* 1304 - DS8M PLUS	1304,00	51,34	163
* 1312 - DS8M PLUS	1312,00	51,65	164
* 1344 - DS8M PLUS	1344,00	52,91	168
* 1368 - DS8M PLUS	1368,00	53,86	171
* 1400 - DS8M PLUS	1400,00	55,12	175
* 1408 - DS8M PLUS	1408,00	55,43	176
* 1440 - DS8M PLUS	1440,00	56,69	180
* 1480 - DS8M PLUS	1480,00	58,27	185
* 1512 - DS8M PLUS	1512,00	59,53	189
* 1552 - DS8M PLUS	1552,00	61,10	194
* 1600 - DS8M PLUS	1600,00	62,99	200
* 1624 - DS8M PLUS	1624,00	63,94	203
* 1760 - DS8M PLUS	1760,00	69,29	220
* 1776 - DS8M PLUS	1776,00	69,92	222
* 1800 - DS8M PLUS	1800,00	70,87	225
* 1816 - DS8M PLUS	1816,00	71,50	227
* 1912 - DS8M PLUS	1912,00	75,28	239
* 2240 - DS8M PLUS	2240,00	88,19	280
* 2392 - DS8M PLUS	2392,00	94,17	299

RO-DRIVE TWIN Double-Sided Synchronous Belts

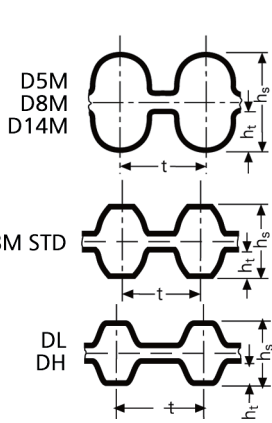

SECTION		D5M	D8M	D14M	DS8M STD	DL	DH
Tooth pitch	t [mm]	5	8	14	8	9,525	12,7
Tooth height	h_t [mm]	2,00	3,20	6,00	3,00	1,91	2,29
Belt thickness	h_s [mm]	5,2	7,8	13,7	7,3	4,6	5,9

* On request

Section D5M DHTD

Section	L_w (mm)	L_w (inch)	z
565 - D5M	565,00	22,24	113
600 - D5M	600,00	23,62	120
615 - D5M	615,00	24,21	123
620 - D5M	620,00	24,41	124
630 - D5M	630,00	24,80	126
635 - D5M	635,00	25,00	127
665 - D5M	665,00	26,18	133
700 - D5M	700,00	27,56	140
710 - D5M	710,00	27,95	142
740 - D5M	740,00	29,13	148
755 - D5M	755,00	29,72	151
800 - D5M	800,00	31,50	160
835 - D5M	835,00	32,87	167
840 - D5M	840,00	33,07	168
* 850 - D5M	850,00	33,46	170
860 - D5M	860,00	33,86	172
890 - D5M	890,00	35,04	178
900 - D5M	900,00	35,43	180
925 - D5M	925,00	36,42	185
* 950 - D5M	950,00	37,40	190
1000 - D5M	1000,00	39,37	200
1050 - D5M	1050,00	41,34	210
* 1100 - D5M	1100,00	43,31	220
1125 - D5M	1125,00	44,29	225
1200 - D5M	1200,00	47,24	240
1270 - D5M	1270,00	50,00	254
1420 - D5M	1420,00	55,91	284
1500 - D5M	1500,00	59,06	300
1595 - D5M	1595,00	62,80	319
1690 - D5M	1690,00	66,54	338
* 1790 - D5M	1790,00	70,47	358
* 1800 - D5M	1800,00	70,87	360
* 1870 - D5M	1870,00	73,62	374
* 1985 - D5M	1985,00	78,15	379
2000 - D5M	2000,00	78,74	400

Section D8M DHTD

Section	L_w (mm)	L_w (inch)	z
880 - D8M	880,00	34,65	110
912 - D8M	912,00	35,91	114
920 - D8M	920,00	36,22	115
960 - D8M	960,00	37,80	120
1040 - D8M	1040,00	40,94	130
1120 - D8M	1120,00	44,09	140
1200 - D8M	1200,00	47,24	150
* 1224 - D8M	1224,00	48,19	153
1280 - D8M	1280,00	50,39	160
1304 - D8M	1304,00	51,34	163
1328 - D8M	1328,00	52,28	166
1360 - D8M	1360,00	53,54	170
1424 - D8M	1424,00	56,06	178
1440 - D8M	1440,00	56,69	180
1600 - D8M	1600,00	62,99	200
1760 - D8M	1760,00	69,29	220
1800 - D8M	1800,00	70,87	225
2000 - D8M	2000,00	78,74	250
* 2200 - D8M	2200,00	86,61	275
2248 - D8M	2248,00	88,50	281
2400 - D8M	2400,00	94,49	300
2600 - D8M	2600,00	102,36	325
* 2800 - D8M	2800,00	110,24	350
* 3048 - D8M	3048,00	120,00	381
* 3280 - D8M	3280,00	129,13	381
* 3600 - D8M	3600,00	141,73	450
* 4400 - D8M	4400,00	173,23	550

Section D14M DHTD

Section	L_w (mm)	L_w (inch)	z
966 - D14M	966,00	38,03	69
1190 - D14M	1190,00	46,85	85
1400 - D14M	1400,00	55,12	100
1610 - D14M	1610,00	63,39	115
* 1764 - D14M	1764,00	69,45	126
1778 - D14M	1778,00	70,00	127
1890 - D14M	1890,00	74,41	135
2100 - D14M	2100,00	82,68	150
2310 - D14M	2310,00	90,94	165
* 2450 - D14M	2450,00	96,46	175
* 2590 - D14M	2590,00	101,97	185
* 2800 - D14M	2800,00	110,24	200
* 3150 - D14M	3150,00	124,02	225
* 3360 - D14M	3360,00	132,28	240
* 3500 - D14M	3500,00	137,80	250
* 3850 - D14M	3850,00	151,57	275
* 4326 - D14M	4326,00	170,31	309
* 4578 - D14M	4578,00	180,24	327
* 4956 - D14M	4956,00	195,12	354

Section D8M DHTD

Section	L_w (mm)	L_w (inch)	z
600 - D8M	600,00	23,62	75
624 - D8M	624,00	24,57	78
* 632 - D8M	632,00	24,88	79
640 - D8M	640,00	25,20	80
656 - D8M	656,00	25,83	82
* 680 - D8M	680,00	26,77	85
720 - D8M	720,00	28,35	90
776 - D8M	776,00	30,55	97
784 - D8M	784,00	30,87	98
800 - D8M	800,00	31,50	100
* 840 - D8M	840,00	33,07	105

RO-DRIVE TWIN Double-Sided Synchronous Belts

Section DS8M DSTD

Section	L _w (mm)	L _w (inch)	z
* 600 - DS8M	600,00	23,62	75
* 632 - DS8M	632,00	24,88	79
* 640 - DS8M	640,00	25,20	80
* 656 - DS8M	656,00	25,83	82
* 672 - DS8M	672,00	26,46	84
* 688 - DS8M	688,00	27,09	86
* 696 - DS8M	696,00	27,40	87
* 712 - DS8M	712,00	28,03	89
* 720 - DS8M	720,00	28,35	90
* 728 - DS8M	728,00	28,66	91
* 736 - DS8M	736,00	28,98	92
* 760 - DS8M	760,00	29,92	95
* 768 - DS8M	768,00	30,24	96
* 784 - DS8M	784,00	30,87	98
* 792 - DS8M	792,00	31,18	99
* 800 - DS8M	800,00	31,50	100
* 824 - DS8M	824,00	32,44	103
* 848 - DS8M	848,00	33,39	106
* 864 - DS8M	864,00	34,02	108
* 880 - DS8M	880,00	34,65	110
* 912 - DS8M	912,00	35,91	114
* 920 - DS8M	920,00	36,22	115
* 944 - DS8M	944,00	37,17	118
* 960 - DS8M	960,00	37,80	120
* 992 - DS8M	992,00	39,06	124
* 1000 - DS8M	1000,00	39,37	125
* 1056 - DS8M	1056,00	41,57	132
* 1064 - DS8M	1064,00	41,89	133
* 1072 - DS8M	1072,00	42,20	134
* 1120 - DS8M	1120,00	44,09	140
* 1136 - DS8M	1136,00	44,72	142
* 1160 - DS8M	1160,00	45,67	145
* 1168 - DS8M	1168,00	45,98	146
* 1176 - DS8M	1176,00	46,30	147
* 1184 - DS8M	1184,00	46,61	148
* 1200 - DS8M	1200,00	47,24	150
* 1216 - DS8M	1216,00	47,87	152
* 1240 - DS8M	1240,00	48,82	155
* 1256 - DS8M	1256,00	49,45	157
* 1264 - DS8M	1264,00	49,76	158
* 1280 - DS8M	1280,00	50,39	160
* 1296 - DS8M	1296,00	51,02	162
* 1304 - DS8M	1304,00	51,34	163
* 1312 - DS8M	1312,00	51,65	164
* 1344 - DS8M	1344,00	52,91	168
* 1368 - DS8M	1368,00	53,86	171
* 1400 - DS8M	1400,00	55,12	175
* 1408 - DS8M	1408,00	55,43	176
* 1440 - DS8M	1440,00	56,69	180
* 1480 - DS8M	1480,00	58,27	185
* 1512 - DS8M	1512,00	59,53	189
* 1552 - DS8M	1552,00	61,10	194
* 1600 - DS8M	1600,00	62,99	200
* 1624 - DS8M	1624,00	63,94	203
* 1760 - DS8M	1760,00	69,29	220
* 1776 - DS8M	1776,00	69,92	222
* 1800 - DS8M	1800,00	70,87	225
* 1816 - DS8M	1816,00	71,50	227
* 1912 - DS8M	1912,00	75,28	239
* 2240 - DS8M	2240,00	88,19	280
* 2392 - DS8M	2392,00	94,17	299

Section DL

Section	L _w (mm)	L _w (inch)	z
* 210 DL	533,40	21,00	56
* 225 DL	571,50	22,50	60
* 240 DL	609,60	24,00	64
* 255 DL	647,70	25,50	68
* 270 DL	658,80	25,94	72
* 285 DL	723,90	28,50	76
* 300 DL	762,00	30,00	80
* 322 DL	819,15	32,25	86
* 345 DL	876,30	34,50	92
* 367 DL	933,45	36,75	98
* 390 DL	990,60	39,00	104
* 420 DL	1066,80	42,00	112
* 450 DL	1143,00	45,00	120
* 480 DL	1219,20	48,00	128
* 510 DL	1295,40	51,00	136
* 540 DL	1371,60	54,00	144
* 600 DL	1524,00	60,00	160
* 660 DL	1676,40	66,00	176

Section DH

Section	L _w (mm)	L _w (inch)	z
* 240 DH	609,60	24,00	48
270 DH	685,80	27,00	54
300 DH	762,00	30,00	60
330 DH	838,20	33,00	66
335 DH	850,90	33,50	67
360 DH	914,40	36,00	72
370 DH	939,80	37,00	74
390 DH	990,60	39,00	78
420 DH	1066,80	42,00	84
450 DH	1143,00	45,00	90
480 DH	1219,20	48,00	96
510 DH	1295,40	51,00	102
540 DH	1371,60	54,00	108
570 DH	1447,80	57,00	114
600 DH	1524,00	60,00	120
630 DH	1600,20	63,00	126
660 DH	1676,40	66,00	132
700 DH	1778,00	70,00	140
730 DH	1854,20	73,00	146
750 DH	1905,00	75,00	150
* 800 DH	2032,00	80,00	160
* 850 DH	2159,00	85,00	170
* 900 DH	2286,00	90,00	180
* 1000 DH	2540,00	100,00	200
* 1100 DH	2794,00	110,00	220
* 1250 DH	3175,00	125,00	250
* 1400 DH	3556,00	140,00	280
* 1700 DH	4318,00	170,00	340

Section DL

Section	L _w (mm)	L _w (inch)	z
* 124 DL	314,33	12,38	33
* 150 DL	381,00	15,00	40
* 187 DL	476,25	18,75	50

RO-DRIVE Open Ended Synchronous Belts

SECTION		5M HTD	8M HTD	S8M STD
5M HTD 8M HTD	Tooth pitch	t [mm]	5	8
	Tooth height	h_t [mm]	2,10	2,95
	Belt thickness	h_s [mm]	3,6	5,3

	<p>* On request</p>
--	---------------------

Section 5M HTD

Width (mm)	Width (inch)	Roll length (m)
15 *	0,59	62

Section 8M HTD

Width (mm)	Width (inch)	Roll length (m)
10 *	0,39	72
12 *	0,47	60
15 *	0,59	48

Section S8M STD

Width (mm)	Width (inch)	Roll length (m)
12 *	0,47	60
15 *	0,59	48

ROFLEX-VARI Raw-Edge Cogged Belts

Section 70 x 18

Inner length (inch)	Inner length (inch)	ROULUNDS Number
* 1455	57,28	70K1568PR
1497	58,94	70K1610PR
* 1512	59,53	70K1625PR
1597	62,87	70K1710PR
1697	66,81	70K1810PR
1705	67,13	70K1818PR
* 1767	69,57	70K1880PR
1797	70,75	70K1910PR
1897	74,68	70K2010PR
* 1922	75,67	70K2035PR
1997	78,62	70K2110PR
* 2012	79,21	70K2125PR
* 2062	81,18	70K2175PR
* 2117	83,35	70K2230PR
* 2226	87,64	70K2339PR
2237	88,07	70K2350PR
* 2357	92,80	70K2470PR
2387	93,98	70K2500MR
* 2497	98,31	70K2610PR
* 2531	99,65	70K2644PR
* 2637	103,82	70K2750PR
2797	110,12	70K2910PR
* 3057	120,35	70K3170PR
3147	123,90	70K3260PR
* 3257	128,23	70K3370PR

Section 98 x 23

Inner length (inch)	Inner length (inch)	ROULUNDS Number
* 1692	66,61	98P1802VR
* 1855	73,03	98N1950VR

Section 70 x 20

Inner length (inch)	Inner length (inch)	ROULUNDS Number
1444	56,85	70K1570SR
* 1499	59,02	70K1625SR
* 1599	62,95	70K1725SR
1699	66,89	70K1825SR
1799	70,83	70K1925SR
1999	78,70	70K2125SR
2239	88,15	70K2365SR
2499	98,39	70K2625SR
2799	110,20	70K2925SR

Section 72 x 20

Inner length (inch)	Inner length (inch)	ROULUNDS Number
* 3150	124,02	72K3275SR

Section 83 x 23

Inner length (inch)	Inner length (inch)	ROULUNDS Number
1691	66,57	83L1836VR
1755	69,09	83L1900VR
1891	74,45	83L2036VR
* 2110	83,07	83K2255VR
* 2131	83,90	83L2276VR
* 2391	94,13	83L2536VR
* 2691	105,94	83L2836VR
* 3041	119,72	83L3186VR
* 3441	135,47	83L3586VR
* 3450	135,83	83L3595WR
* 3700	145,67	83L3845WR
* 3891	153,19	83L4036VR

CROSS-LIST RMA Notation - ROULUNDS Number

RMA Notation	ROULUNDS Number	RMA Notation	ROULUNDS Number	RMA Notation	ROULUNDS Number
1422 V 172	22H0450DR	2322 V 390	37J1010FR	3230 V 557	52J1440MR
1422 V 172	22H0450DR	2322 V 410	37J1060FR	3230 V 580	52J1500MR
1422 V 192	22H0450DR	2322 V 435	37J1120FR	3230 V 630	52J1625MR
1422 V 192	22H0450DR	2322 V 458	37J1180FR	3230 V 660	52J1700MR
1422 V 205	22H0535DR	2322 V 482	37J1240FR	3230 V 710	52J1825MR
1422 V 212	22H0550DR	2322 V 487	37J1252FR	3230 V 787	52J2025MR
1422 V 220	22H0575DR	2322 V 510	37J1310FR	3230 V 882	52J2265MR
1422 V 230	22H0600DR	2322 V 537	37J1380FR	3230 V 985	52J2525MR
1422 V 240	22H0625DR	2322 V 570	37J1460FR	3230 V 1102	52J2825MR
1422 V 250	22H0650DR	2322 V 608	37J1560FR	3230 V 1240	52J3175MR
1422 V 255	22H0660DR	2322 V 647	37J1660FR	4436 V 505	70K1310PR
1422 V 260	22H0675DR	2322 V 660	37J1695FR	4436 V 530	70K1374PR
1422 V 270	22H0700DR	2322 V 687	37J1760FR	4436 V 552	70K1430PR
1422 V 280	22H0725DR	2322 V 725	37J1860FR	4436 V 583	70K1510PR
1422 V 290	22H0750DR	2322 V 765	37J1960FR	4436 V 605	70K1568PR
1422 V 300	22H0775DR	2322 V 805	37J2060FR	4436 V 623	70K1610PR
1422 V 310	22H0800DR	2322 V 825	37J2113FR	4436 V 662	70K1710PR
1422 V 320	22H0825DR	2322 V 830	37J2125FR	4436 V 700	70K1810PR
1422 V 330	22H0850DR	2322 V 852	37J2180FR	4436 V 730	70K1882PR
1422 V 340	22H0875DR	2322 V 875	37J2240FR	4436 V 740	70K1910PR
1422 V 350	22H0900DR	2322 V 900	37J2300FR	4436 V 780	70K2010PR
1422 V 370	22H0950DR	2322 V 1002	37J2560FR	4436 V 780	70K2013PR
1422 V 390	22H1000DR	2322 V 1120	37J2860FR	4436 V 820	70K2110PR
1422 V 408	22H1050DR	2926 V 340	47J0880HR	4436 V 845	70K2175PR
1422 V 432	22H1110DR	2926 V 360	47J0930HR	4436 V 860	70K2213PR
1422 V 455	22H1170DR	2926 V 370	47J0955HR	4436 V 867	70K2230PR
1422 V 480	22H1230DR	2926 V 378	47J0980HR	4436 V 910	70K2339PR
1422 V 497	22H1275DR	2926 V 398	47J1030HR	4436 V 915	70K2350PR
1422 V 507	22H1300DR	2926 V 418	47J1080HR	4436 V 1015	70K2610PR
1422 V 535	22H1370DR	2926 V 430	47J1110HR	4436 V 1030	70K2644PR
1422 V 565	22H1450DR	2926 V 440	47J1140HR	4436 V 1135	70K2910PR
1422 V 605	22H1550DR	2926 V 465	47J1200HR	4436 V 1272	70K3260PR
1422 V 645	22H1650DR	2926 V 475	47J1225HR	4436 V 1418	70K3630PR
1422 V 660	22H1690DR	2926 V 490	47J1260HR	4436 V 605	70K1570SR
1422 V 685	22H1750DR	2926 V 495	47J1275HR	4436 V 667	70K1725SR
1422 V 723	22H1850DR	2926 V 515	47J1330HR	4436 V 705	70K1825SR
1422 V 1000	22H2550DR	2926 V 525	47J1350HR	4436 V 745	70K1925SR
1922 V 262	30H0680FR	2926 V 545	47J1400HR	4436 V 825	70K2125SR
1922 V 275	30H0713FR	2926 V 575	47J1480HR	4436 V 920	70K2365SR
1922 V 315	30H0818FR	2926 V 590	47J1515HR	4436 V 1020	70K2625SR
1922 V 335	30H0863FR	2926 V 615	47J1580HR	4436 V 1140	70K2925SR
1922 V 365	30H0940FR	2926 V 640	47J1645HR		
1922 V 373	30H0963FR	2926 V 655	47J1680HR		
1922 V 383	30H0988FR	2926 V 670	47J1720HR		
1922 V 393	30H1013FR	2926 V 693	47J1780HR		
1922 V 405	30H1048FR	2926 V 710	47J1820HR		
1922 V 412	30H1063FR	2926 V 733	47J1880HR		
1922 V 440	30H1135FR	2926 V 722	47J1980HR		
1922 V 453	30H1167FR	2926 V 780	47J2000HR		
1922 V 460	30H1183FR	2926 V 810	47J2080HR		
1922 V 482	30H1241FR	2926 V 860	47J2200HR		
1922 V 545	30H1400FR	2926 V 895	47J2290HR		
1922 V 583	30H1496FR	2926 V 905	47J2320HR		
1922 V 600	30H1537FR	2926 V 930	47J2380HR		
1922 V 605	30H1555FR	2926 V 953	47J2440HR		
1922 V 688	30H1763FR	2926 V 970	47J2480HR		
1922 V 727	30H1863FR	2926 V 1005	47J2575HR		
1922 V 750	30H1920FR	2926 V 1008	47J2580HR		
2322 V 255	37J0660FR	2926 V 1120	47J2860HR		
2322 V 273	37J0710FR	2926 V 1125	47J2880HR		
2322 V 283	37J0735FR	3226 V 597	50J1538KR		
2322 V 293	37J0760FR	3226 V 623	50J1605KR		
2322 V 303	37J0785FR	3226 V 925	50K2374KR		
2322 V 313	37J0810FR	3230 V 495	52J1280MR		
2322 V 332	37J0860FR	3230 V 522	52J1350MR		
2322 V 340	37J0880FR	3230 V 533	52J1380MR		
2322 V 352	37J0910FR	3230 V 549	52J1420MR		
2322 V 372	37J0960FR	3230 V 551	52J1425MR		

CROSS-LIST ISO Notation - ROULUNDS Number

ISO Bezeichnung	ROULUNDS Nummer	ISO Bezeichnung	ROULUNDS Nummer
W 16 440	17H0448BR	W 40 1180	42J1195HR
W 16 480	17H0490BR	W 40 1250	42J1269HR
W 16 500	17H0508BR	W 40 1305	42J1325HR
W 16 530	17H0540BR	W 40 1400	42J1419HR
W 16 560	17H0568BR	W 40 1455	42J1475HR
W 16 580	17H0590BR	W 40 1500	42J1519HR
W 16 600	17H0608BR	W 40 1600	42J1619HR
W 16 630	17H0640BR	W 40 1655	42J1675HR
W 16 680	17H0690BR	W 40 1755	42J1775HR
W 16 730	17H0740BR	W 40 1855	42J1875HR
W 16 780	17H0790BR	W 40 2000	42J2019HR
W 16 800	17H0808BR	W 40 2055	42J2075HR
W 16 830	17H0840BR	W 40 2240	42J2259HR
W 16 880	17H0890BR	W 40 2500	42J2519HR
W 16 900	17H0908BR	W 50 1120	52J1145MR
W 16 930	17H0940BR	W 50 1250	52J1280MR
W 16 1030	17H1040BR	W 50 1400	52J1425MR
W 16 1080	17H1090BR	W 50 1600	52J1625MR
W 16 1130	17H1140BR	W 50 1675	52J1700MR
W 16 1180	17H1190BR	W 50 1800	52J1825MR
W 16 1230	17H1240BR	W 50 2000	52J2025MR
W 16 1280	17H1290BR	W 50 2240	52J2265MR
W 20 560	21H0570BR	W 50 2500	52J2525MR
W 20 630	21H0640BR	W 50 2800	52J2825MR
W 20 710	21H0720BR	W 50 3150	52J3175MR
W 20 800	21H0810BR	W 63 1600	58J2610NR
W 20 900	21H0910BR	W 63 1800	65K1832SR
W 20 1000	21H1010BR	W 63 2000	65K2032SR
W 20 1120	21H1130BR	W 63 2240	65K2272SR
W 20 1250	21H1260BR	W 63 2500	65K2532SR
W 25 560	26H0572DR	W 63 2800	65K2832SR
W 25 630	26H0642DR	W 63 3150	65K3182SR
W 25 710	26H0722DR	W 63 3550	65K3582SR
W 25 745	26H0760DR	W 63 4000	65K4032SR
W 25 785	26H0800DR	W 80 1800	83L1836VR
W 25 800	26H0812DR	W 80 2000	83L2036VR
W 25 835	26H0850DR	W 80 2240	83L2276VR
W 25 885	26H0900DR	W 80 2500	83L2536VR
W 25 900	26H0912DR	W 80 2800	83L2836VR
W 25 935	26H0950DR	W 80 3150	83L3186VR
W 25 1000	26H1012DR	W 80 3550	83L3586VR
W 25 1035	26H1050DR	W 80 4000	83L4036VR
W 25 1120	26H1132DR		
W 25 1155	26H1170DR		
W 25 1250	26H1262DR		
W 25 1400	26H1412DR		
W 25 1600	26H1612DR		
W 31,5 800	32H0813FR		
W 31,5 840	32H0853FR		
W 31,5 870	32H0883FR		
W 31,5 900	32H0913FR		
W 31,5 950	32H0963FR		
W 31,5 1000	32H1013FR		
W 31,5 1050	32H1063FR		
W 31,5 1120	32H1136FR		
W 31,5 1170	32H1183FR		
W 31,5 1230	32H1243FR		
W 31,5 1250	32H1266FR		
W 31,5 1300	32H1313FR		
W 31,5 1450	32H1463FR		
W 31,5 1600	32H1616FR		
W 31,5 1650	32H1663FR		
W 31,5 1800	32H1813FR		
W 31,5 2000	32H2016FR		
W 40 955	42J0975HR		
W 40 1000	42J1013HR		
W 40 1060	42J1075HR		
W 40 1120	42J1139HR		

The content of this publication is provided for information only and without responsibility.

ContiTech Roulunds Rubber A/S's obligations and responsibilities regarding its products are governed solely by the agreements under which they are sold. Unless otherwise agreed in writing, the information contained herein does not become part of these agreements. This publication does not contain any guarantee or agreed quality of ContiTech Roulunds Rubber A/S's products or any warranty of merchantability, fitness for a particular purpose and non-infringement. ContiTech Roulunds Rubber A/S may make changes in the products or services described at any time without notice.

This publication is provided on an "as is" basis. To the extent permitted by law, ContiTech Roulunds Rubber A/S makes no warranty, express or implied, and assumes no liability in connection with the use of the information contained in this publication. ContiTech Roulunds Rubber A/S is not liable for any direct, indirect, incidental, consequential or punitive damages arising out of the use of this publication. Information contained herein is not intended to announce product availability anywhere in the world.

Copyright © 2008 ContiTech Roulunds Rubber A/S. All rights reserved.

RUBBER ROULUNDS
ROULUNDS RUBBER
RUBBER ROULUNDS
ROULUNDS RUBBER
RUBBER ROULUNDS
ROULUNDS RUBBER

ROULUNDS
RUBBER